

NEO 1.6

INSERT

INSERT

FOR SMALL TO MEDIUM SPACES

Heat Output Cord Wood

70,000 BTU

40,000 BTU EPA Test Fuel

EFFICIENCY (LHV)	81.3%
EMISSIONS	3.9 GM/HR.
LOG SIZE (MAX)	16-18 IN.
FIRBOX SIZE	1.6 CU.FT.
GLASS SIZE	131 SQ.IN.
WEIGHT	285 LBS.

Even a smaller fireplace can be significant source of wood heat, and you don't have to sacrifice contemporary design or the comfort of a fire in the hearth. The Neo 1.6 insert, for existing masonry fireplaces, is a solid, woodburning insert built of heavy-gauge steel with a cast iron door. With advanced heat exchange technology and a secondary combustion baffle, the Neo 1.6 insert delivers exceptionally clean-burning, energy-efficient heating performance... in a flush profile with a large, clear glass window that reveals the flame inside.

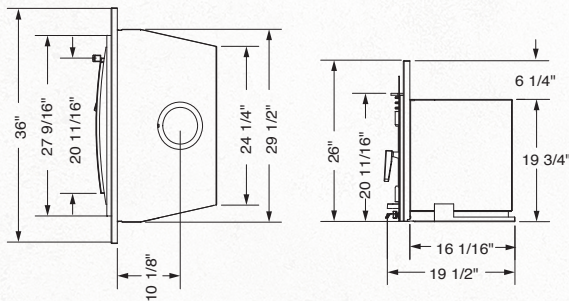

For reference only. Installations should be based on installation manuals. Specifications subject to change.

STANDARD FEATURES

Reliable, durable non-catalytic technology
Air wash system for super clean ceramic glass
High-tech multi-port combustion air injection system
Inside and outside combustion air capable
Floating firebox for extended stove life
Rich Metallic Black finish
304 Stainless Steel Baffle, insulation cover, rails and flame shield
Extended Burn Technology (EBT2)
Two 45 cfm temperature actuated variable speed blower/s
Single-Lever Air Control
Removable Cast-Iron Flue Collar
East-West loading
Integrated Heat Exchanger

DESIGN OPTIONS

Contemporary Surround in Metallic Black or Stainless Steel (36" x 26")
Oversize Surround (46" x 30")



AVAILABLE SURROUNDS

